GeneCafe APP

User Guide

Table of Contents	2p
01. Launch the app	3–4p
1.Install the app	3p
2.Launch the app	3p
3.App main screen	4p
02. Connect device	5p
1.Connect device	5p
2.Activate the menu after connecting the device	5p
03. Roasting	6–10p
1.Roasting screen components	6p
2.Start roasting	7–8p
3.Cooling	9p
4.Save a profile	10p
04. My roasting	11p
1.View and edit profile details	11p
2.Compare profiles	12p
3.Export and import profiles	13p
05. Settings	14p

1 Install the app



- Search for "Gene Cafe" or "제네카페" in the Play Store (Android) or App Store (iOS) on your smartphone and install it.

※ Minimum supported OS version

- Available for Android10 and iOS13 and higher OS versions.
- If you're using a device running Android 10 and iOS 13 or earlier, we recommend updating your OS to the latest version before using the app.



- Your smartphone must have location services and Bluetooth enabled for Bluetooth connectivity.
- Before connecting your device, we recommend that you power on the roaster and have it close at hand. Be aware that you may lose your connection if the distance increases.
- Only one smartphone can be connected to the roaster at a time.
- Bluetooth connections can be unstable if there are a lot of electronics or wireless signals around, so try to use it in an environment with as little interference as possible.
- During roasting, periodically check the Bluetooth connection status, and if the connection is unstable, we recommend manually manipulating it.
- Bluetooth can drain your smartphone's battery quickly, so check the battery status periodically.

2 Launch the app

- Click and launch the 'Gene Cafe' app 

- On the first run, it sets up an authorization request to use the service. Please allow the necessary permissions for Bluetooth connectivity.

※ You must allow all permissions to use the feature smoothly.



3 App main screen

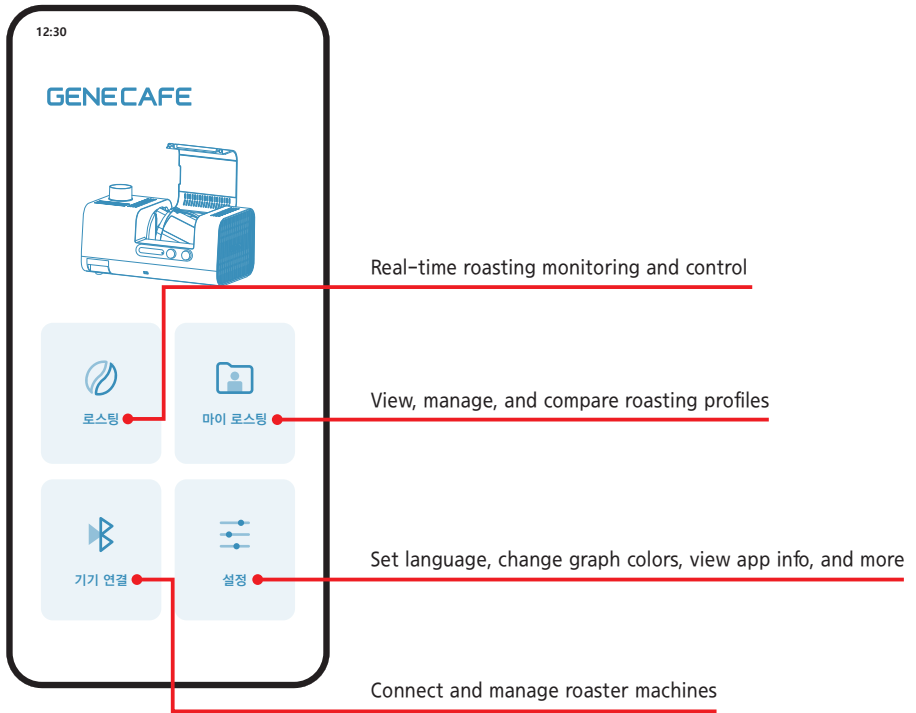

1 Connect device

- ① Click the 'Connect device' menu on the main screen.
- ② The app will search for nearby roasters, and when available roasters appear in the list, select the roaster model you want to connect to.
- ③ Click the 'Connect' button to attempt to connect to the roaster.
- ④ Once the connection is complete, the message 'Connected to device' will be displayed, and the Bluetooth indicator on the device will turn green.
- ⑤ The roasting menu will be activated, allowing you to monitor and control your device in real time

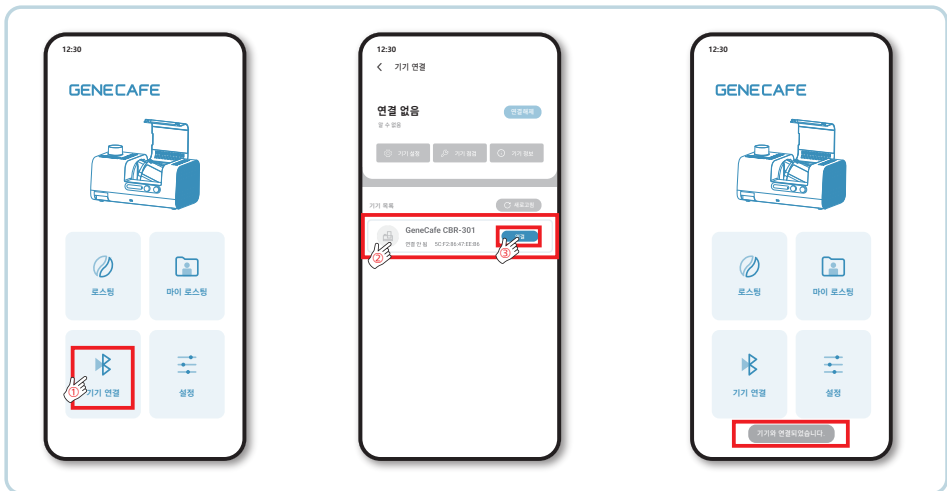

2 Activate the menu after connecting the device

- Once the connection to the roaster is complete, the Device Settings, Device Check, and Device Info menus are enabled.



- ① Device settings
Setting the roaster temperature units and resetting product setpoints
- ② Check the device
Motor/Fan/LED test controls (to verify proper operation of each moving part)
- ③ Device information
Verify device name, MAC address, firmware version, and more

1 Roasting screen components

Click the 'Roasting' menu on the main screen to switch to the roasting screen.
The roasting screen is organized as follows

Real-time graph area
-Top graph: ET & ΔET
-Bottom graph:
Pan and motor speeds

Profile wallpaper setting button ← Screenshot

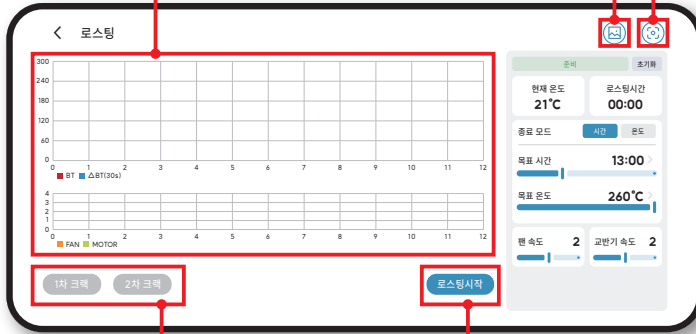

1st/2nd crack record button ←

Mode switch button ←
Start roasting → Cooling → End → Save

Current mode display area
Sleep (standby), Waiting to start roasting, Roasting, Cooling, Cooling complete, Error

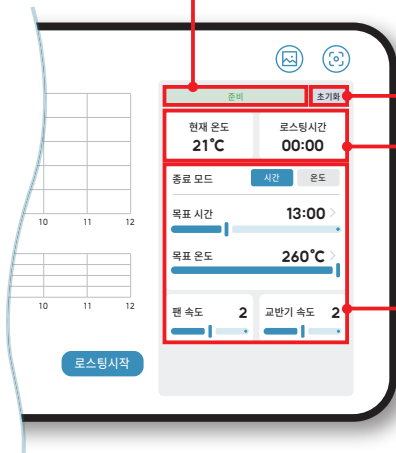

Reset setting button
-Shutdown mode [time]
-Target time [12 minutes]
-Target time [12 minutes]
-Fan speed [level 2]
-Motor speed [level 2]

Current temperature and roasting time display area

Change settings area
-Shutdown mode [time ↔ temperature]
-Target time [5 minutes to 30 minutes]
-Target temperature [60 degrees to 260 degrees]
-Fan speed [1/2/3 steps]
-Motor speed [steps 1/2/3]

2 Start roasting

- ① Set the target temperature and time
 - Once you've set your target temperature and time in the app, click the 'Start Roasting' button.
 - If you started roasting directly from the roaster, the app will automatically detect and integrate the mode switch.

- ② Wait for the roasting to start
 - The green LED on the roaster will flash, and the words 'PUSH' and 'btn' are displayed alternately.
 - The TEMP switch must be pressed within 1 minute to start roasting, and roasting will stop automatically if no button is pressed for 1 minute.
 - ※ For safety reasons, the TEMP switch must be pressed after the roast has started.

- ③ Proceed with roasting
 - When the TEMP switch is pressed to start roasting, the LED on the roaster will change to yellow.
 - ※ Caution: Don't walk away while roasting.



2 Start roasting

- ④ Monitor real-time data and change settings
 - The roast recording starts, and the roasting data is displayed in a real-time graph.
 - The change settings during roasting area allows you to adjust the shutdown mode, target time and temperature, fan speed, and agitator speed.
 - ※ Note: The default value for fan speed and motor speed is level 2, which can cause the graphs to appear overlapping in some areas.
- ⑤ Record the crack time
 - You can click the 'Crack' button at the bottom to record the time of the 1st/2nd crack.
- ⑥ Overheat detection
 - If overheating is detected during roasting, an overheat detection popup appears.
 - At this point, the fan speed will automatically adjust to level 3, and you won't be able to change the fan speed until the temperature stabilizes.
 - Settings other than the fan speed are changeable and will become adjustable again once the overheat condition is cleared.

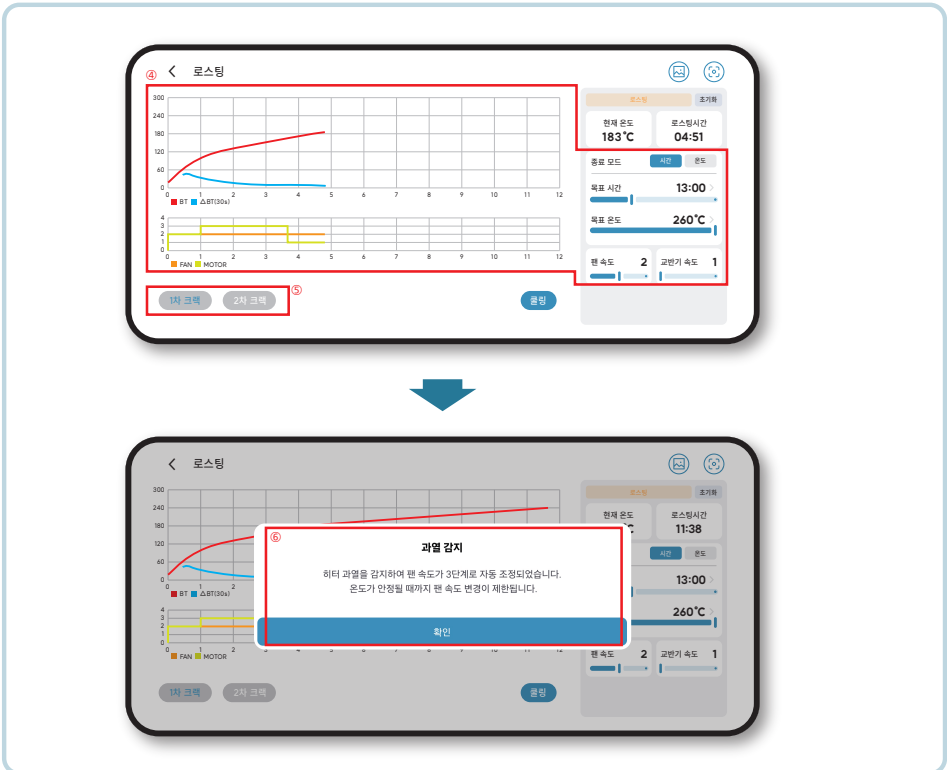

3 Cooling

① Switch cooling mode

- You can put the roaster into cooling mode by pressing the 'Cooling' button.
- If you switch to cooling mode directly from the roaster, the status is automatically synchronized to the app.

② Cooling motion

- The LED on the roaster will turn blue and start cooling.
- When cooling, the fan speed and agitator speed automatically adjust to level 3, and the speed cannot be changed in cooling mode.

③ End cooling

- Cooling will automatically end when the temperature reaches 60 degrees; click the 'End' button to end it immediately.



4 Save a profile

① Save a profile

- Once roasting is complete, you can save the roasting profile by pressing the 'Save' button.

② Enter your profile information

- Enter information such as profile name, green bean information, and dosage, then press the 'OK' button to save.
- Saved profiles can be viewed and modified in the 'My Roasting' menu.

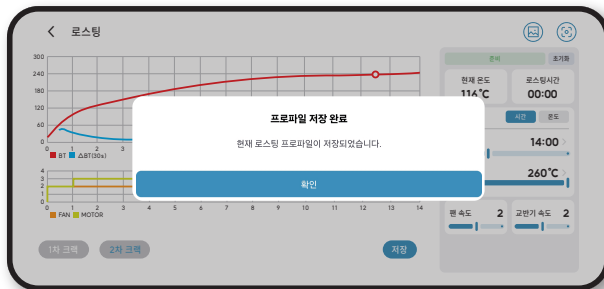
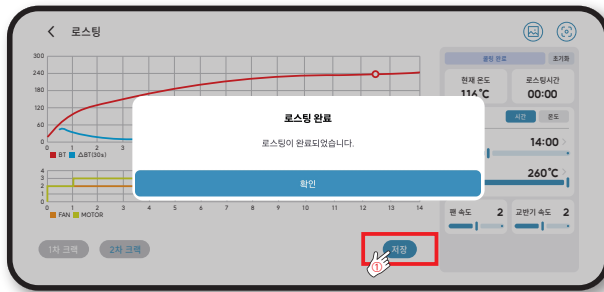

1 View and edit profile details

- Click the 'My Roasting' menu on the main screen to see a list of your saved roasting profiles.
- After you select the desired profile, you can view the profile details.
- Clicking the 'Edit' button will allow you to modify the profile information, and the weight reduction percentage will be calculated automatically when you enter your emissions.
- Click the 'Details' button to see the roasting data in a tabular format.
- You can also write a note or attach a photo.

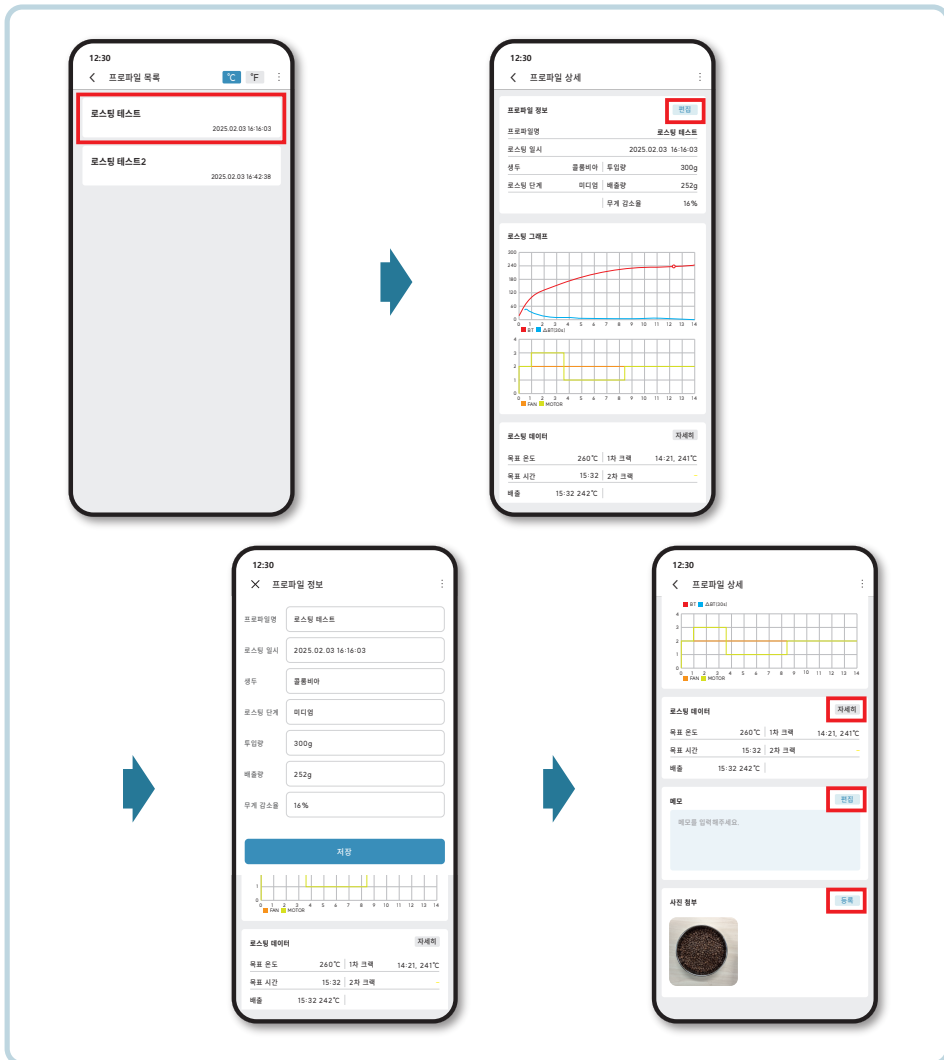

2 Compare profiles

- In the list of profiles, click the right menu button, then select 'Compare profiles.'
- After selecting the two profiles you want to compare, click the 'Compare profiles' button to compare data from the two profiles.

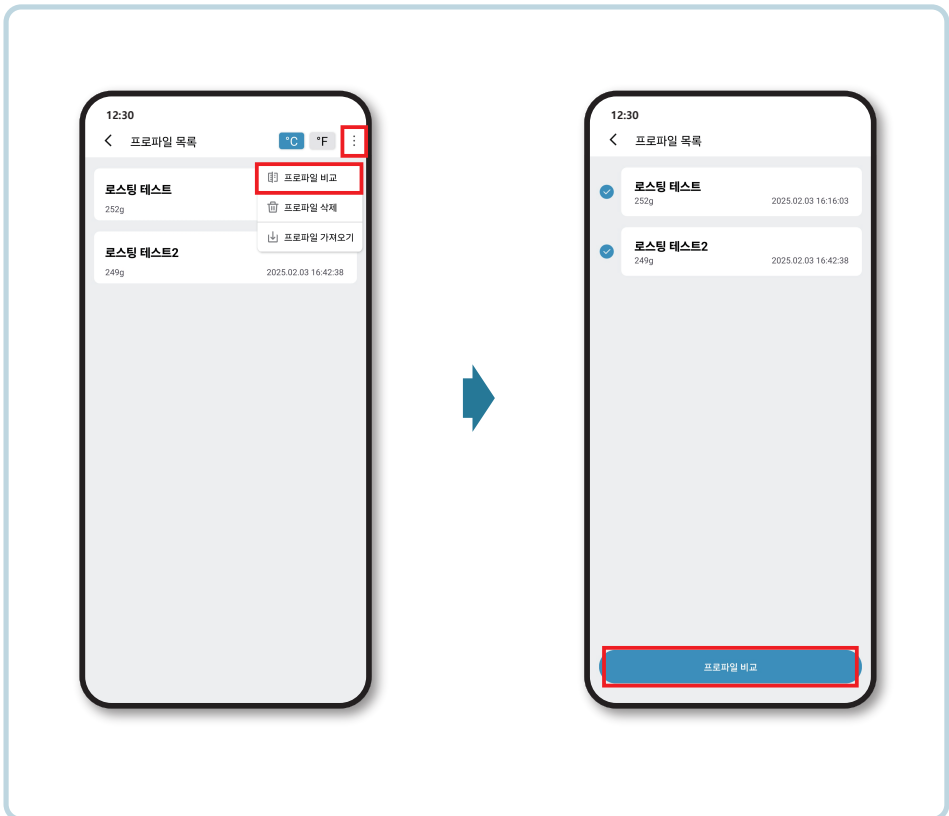

3 Export and import profiles

- The profile export and import feature allows you to share profiles with different users.
- Export profiles: Profile details → Click menu → Export profile
- Import profiles: Profiles list → Click menu → Import profile

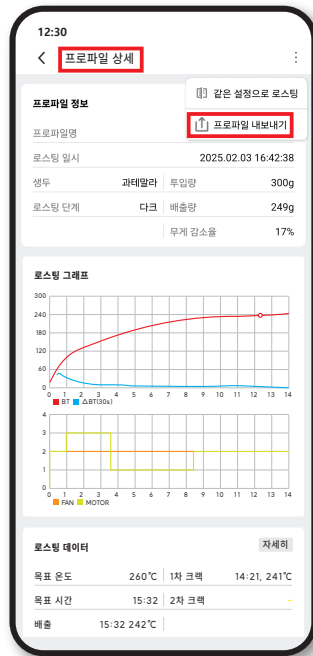
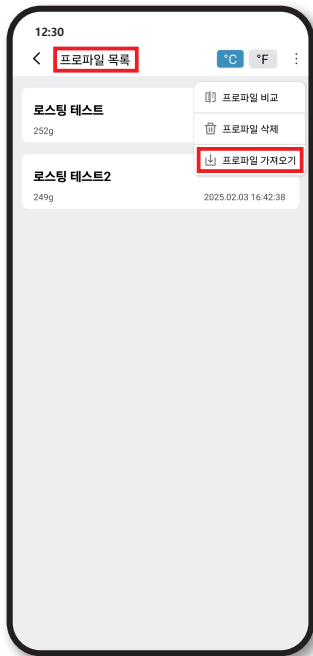

1 Settings menu

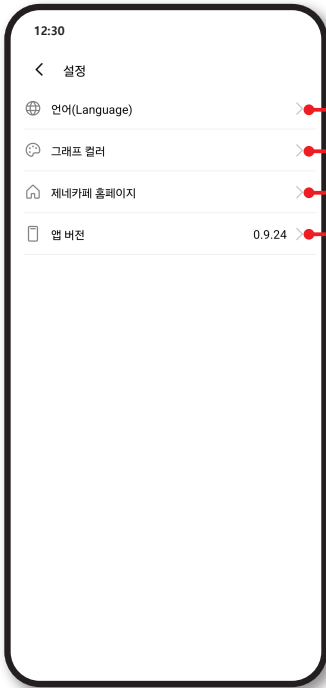

Menu to set the language of your app

Customize the color of graphs on the roasting screen

Go to our official website

Show version information for currently installed apps