

Sweet Maria's

Repair Tip Sheet: Fixing a Scraping StovePop Stirrer

If you've followed the directions included in your StovePop and the stirrer is still jamming against the bottom of the pot and difficult or impossible to turn, we recommend the following adjustment.

1) Lay the lid on a table with the handles on the right and push the stirring handle in as far as it will go.

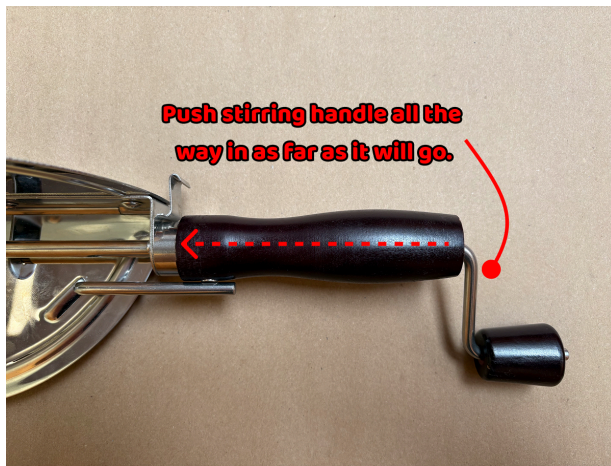

2) If you assembled your popper correctly, the tip of the stir rod should look like this:

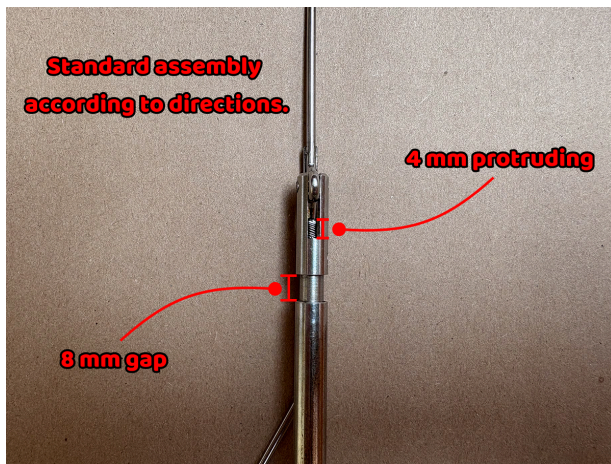

3) Loosen the set screw.

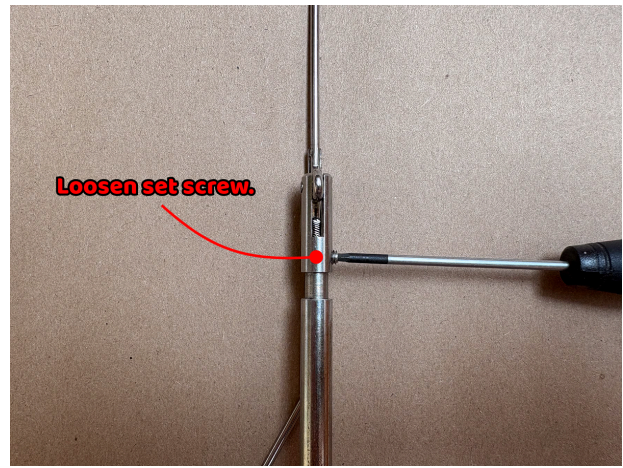

4) Slide the stirrer "up" so that 1mm of the flex cable is visible in the opening and the gap between the stirrer and vertical rod is larger. It should look like this:

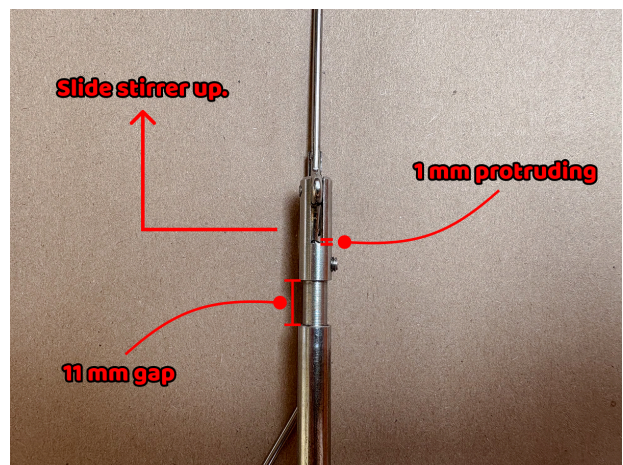

5) Tighten set screw. With lid on, the stirrer should rest on the bottom of the pot but spin easily.