

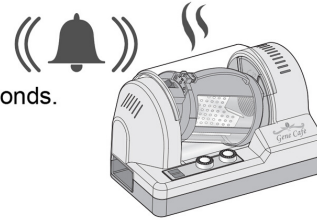

**ATTENTION - PLEASE READ CAREFULLY
ADDENDUM TO THE GENE CAFE CBR-101 USER MANUAL**

NEW Unattended Switch Feature - The CBR-101 has added an automatic unattended safety switch, to ensure users do not leave the roaster unattended while in use.

At 392°F (200°C) and 446°F (230°C) an alarm will sound for 30 seconds.



To continue the roast press the blue "TIME" button. Press
If the TIME button is not pressed during either alarm period, the roaster will automatically start the cooling cycle.



Never leave the roaster unattended when in use. Coffee beans can ignite.



Please read the complete CBR-101 user manual prior to roasting,
for additional information and safety precautions.



**ATTENTION - PLEASE READ CAREFULLY
ADDENDUM TO THE GENE CAFE CBR-101 USER MANUAL**

NEW Unattended Switch Feature - The CBR-101 has added an automatic unattended safety switch, to ensure users do not leave the roaster unattended while in use.

At 392°F (200°C) and 446°F (230°C) an alarm will sound for 30 seconds.

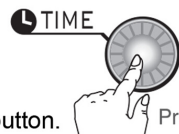
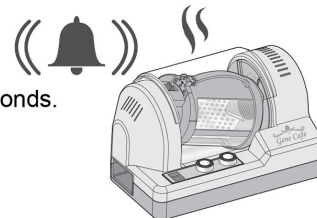

To continue the roast press the blue "TIME" button. Press
If the TIME button is not pressed during either alarm period, the roaster will automatically start the cooling cycle.



Never leave the roaster unattended when in use. Coffee beans can ignite.



Please read the complete CBR-101 user manual prior to roasting,
for additional information and safety precautions.